

Proposed Mixed Use Development - Land North of Blair Avenue Ingleby Barwick - Stockton on Tees

Key:

- 1. Nursery (50 places)
- 2. PCT Building 816m sq Total (408m sq over 2 floors)
- 3. Extra care home

57 Car Parking Spaces
Including 4 Disabled Spaces

Possible Future Residential
Development

Existing Residential

School

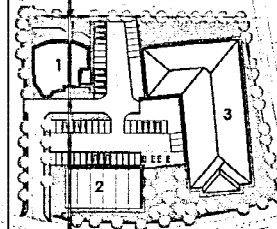

STOCKTON-ON-TEES COUNCIL
PLANNING
13 DEC 2006
DATE RECEIVED

Drg Title: Proposed Site Plan
Drg No: IB002
SCALE: 1:1000@A1
Date: Dec 2006

06/3752/--